

23RD ST ROAD DIET ASKEW TO MANCHESTER TRFY

TYPICAL DETAILS

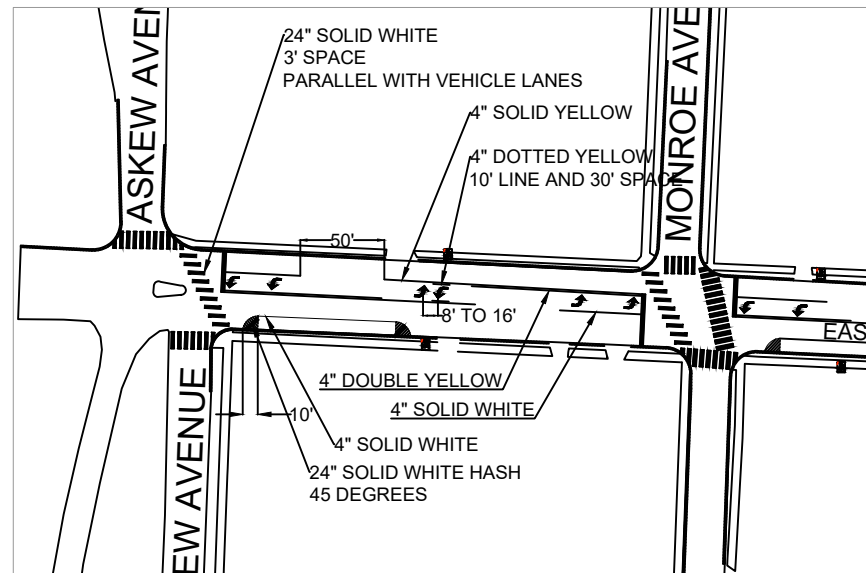

GENERAL NOTES:

1. FOR ALL SIGNING AND STRIPING, FOLLOW THE MUTCD.
2. PROJECT MANAGER IS BAILEY WATERS. 816-888-9685
3. REMOVE ALL "NO PARKING FROM 4-6PM" SIGNS ALONG THE SOUTHERN CURB. PRESERVE THE NO PARKING RIGHT ARROW AND NO PARKING LEFT ARROW SIGNS PRESENT NEAR THE INTERSECTIONS.
4. CROSSWALK MARKINGS AND SIGNAGE WILL BE ADDED WITH RESURFACING. ADA RAMPS WILL BE ADDED IN THE FUTURE ADA CONSTRUCTION CONTRACTS.



ASKEW AVENUE

MONROE AVENUE

CLEVELAND AVENUE

MERSINGTON AVENUE

24" SOLID WHITE
3' SPACE
PARALLEL WITH VEHICLE LANES
4" SOLID YELLOW
4" DOTTED YELLOW
10' LINE AND 30' SPACE

24" YELLOW HASH
45 DEGREES SPACED AT 40'
4" DOUBLE YELLOW

4" DOUBLE YELLOW
4" SOLID WHITE
4" SOLID WHITE
24" SOLID WHITE HASH
45 DEGREES

EAST 23RD STREET

8' TO 16'

10'

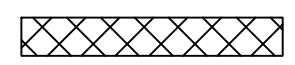



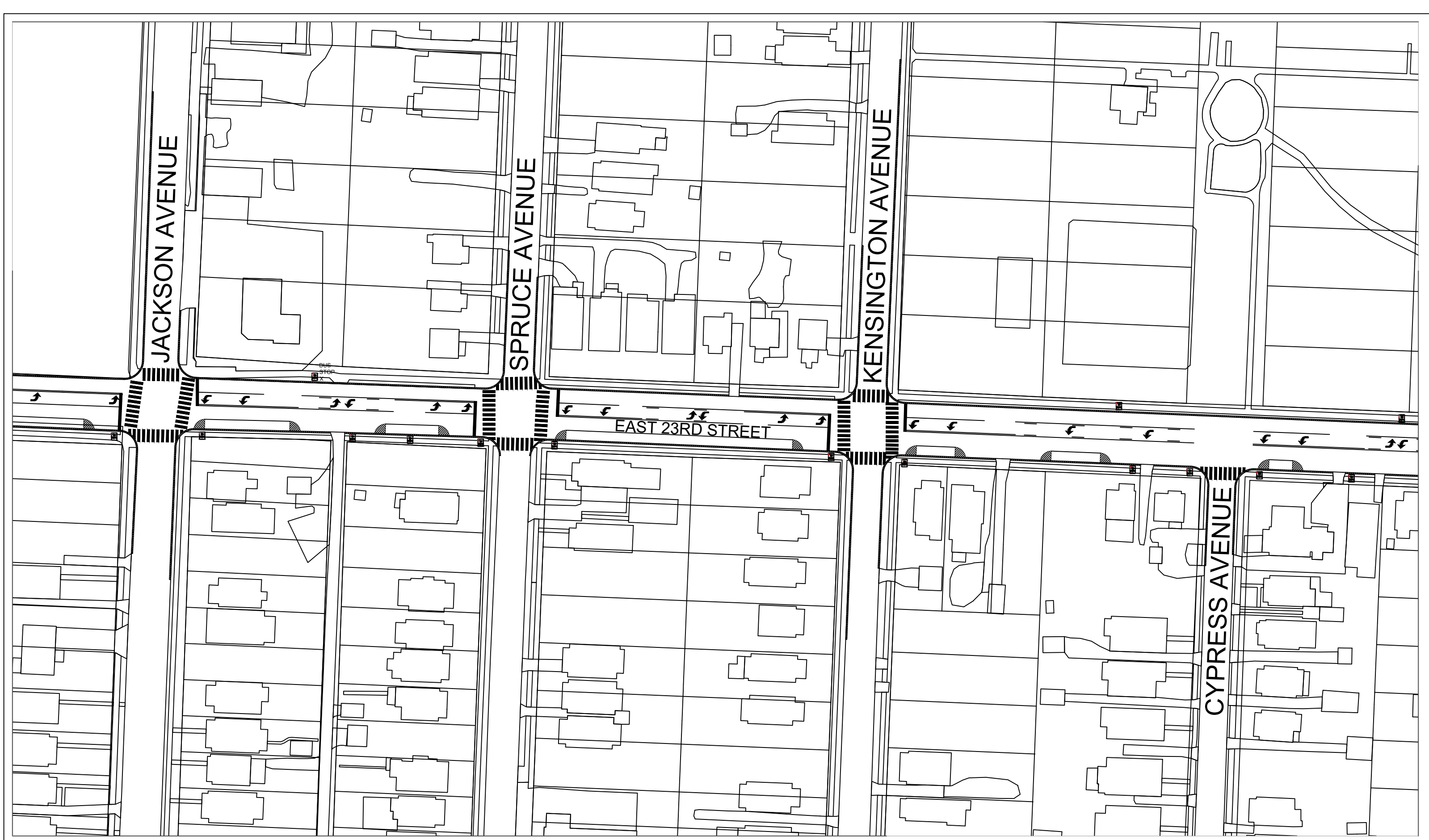

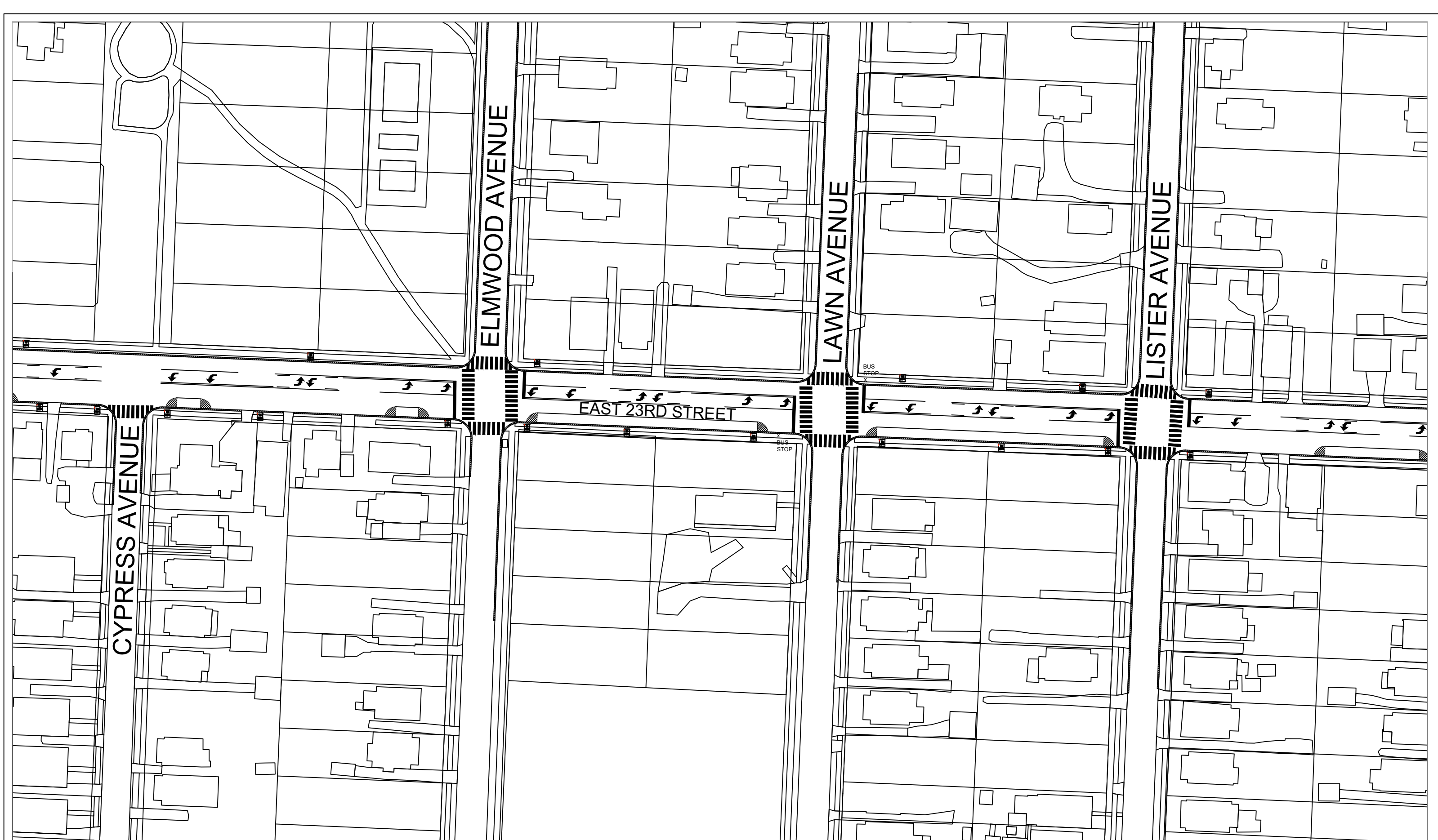

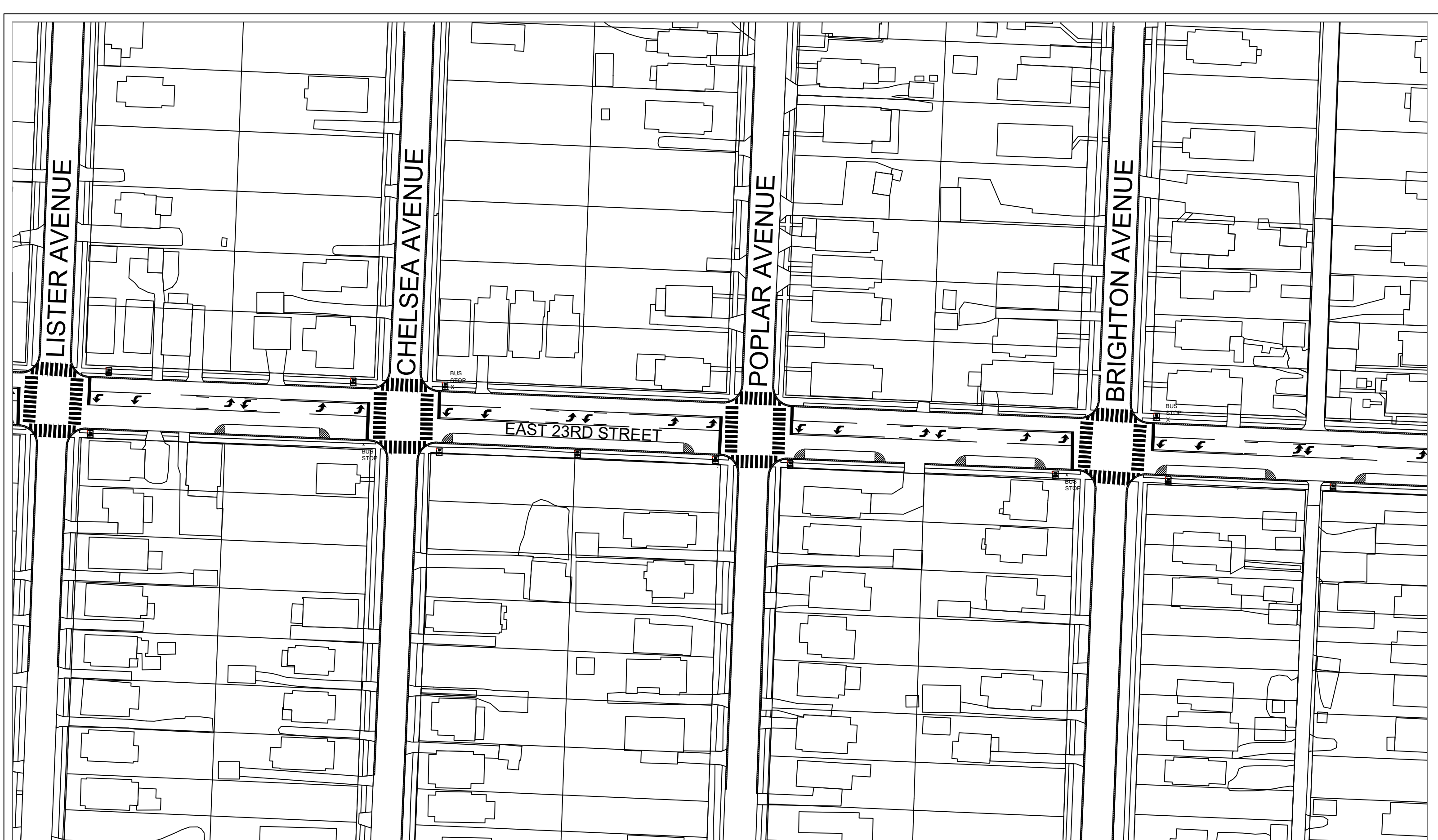

23RD ST STRIPING AND SIGNING

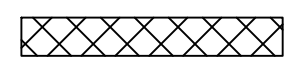

Page 6
No Scale

DRAFT

BRIGHTON AVENUE

QUINCY AVENUE

DENVER AVENUE

VAN BRUNT BLVD

EAST 23RD STREET



23RD ST STRIPING AND SIGNING



Page 7
No Scale

DRAFT

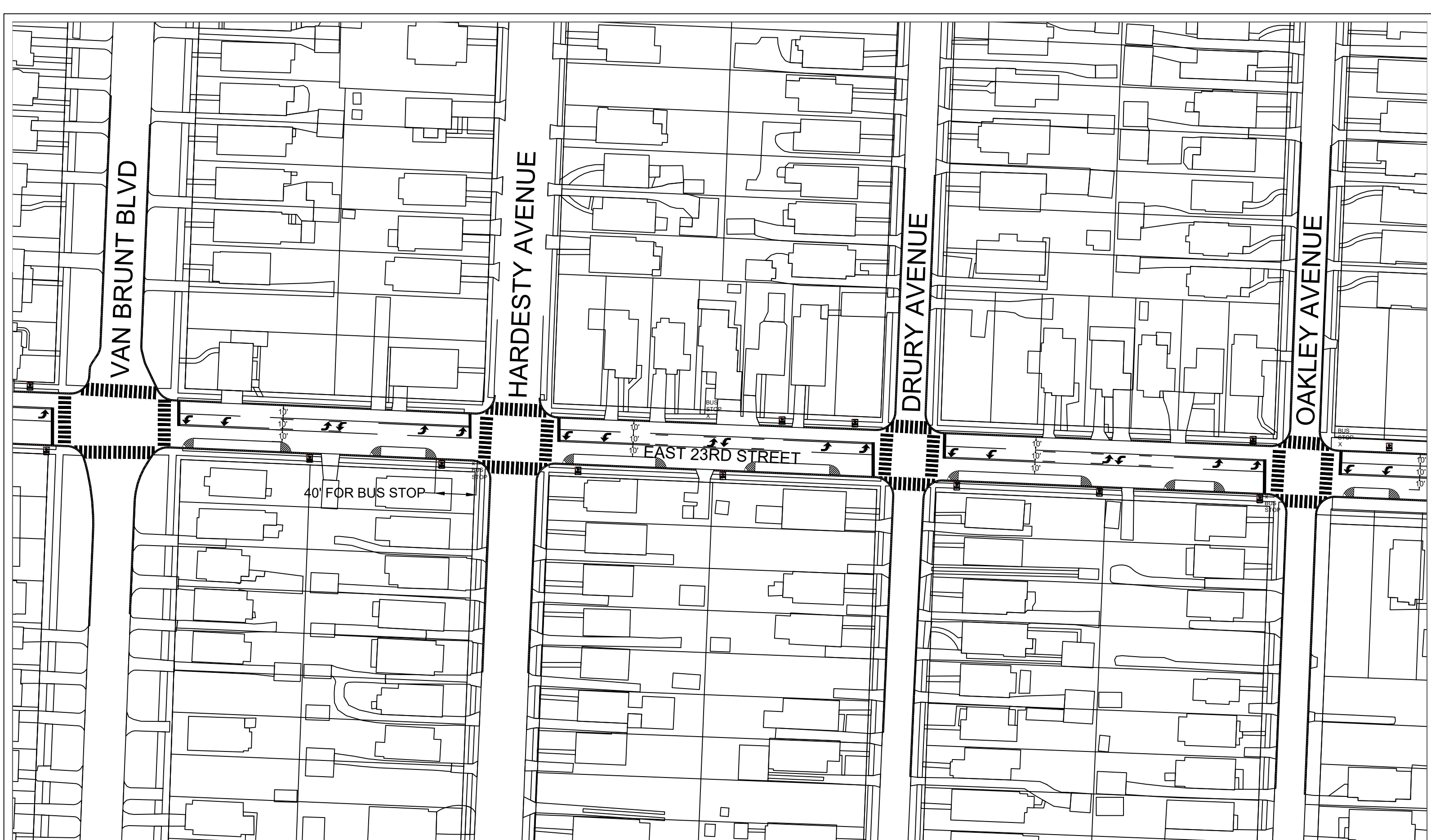

VAN BRUNT BLVD

HARDESTY AVENUE

DRURY AVENUE

OAKLEY AVENUE

EAST 23RD STREET

40' FOR BUS STOP

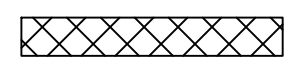

OAKLEY AVENUE

TOPPING AVENUE

EAST 23RD STREET

LAWDALE AVENUE

REPLACE SPEED LIMIT 35 SIGN
WITH SPEED LIMIT 30 SIGN

SPEED
LIMIT
30

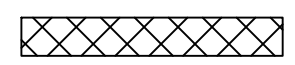

TOPPING AVENUE

WHEELING AVENUE

SPEED LIMIT 30
REPLACE SPEED LIMIT 35 SIGN
WITH SPEED LIMIT 30 SIGN



WHEELING AVENUE

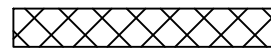
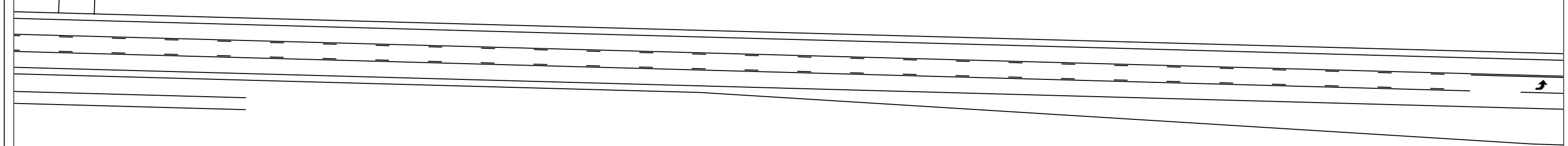

J.A. ROGERS ELEM.

LAYOUT NEAR SCHOOL TO BE
DETERMINED AFTER SCHOOL IS IN
SESSION

J.A. ROGERS ELEM.

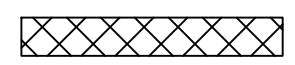
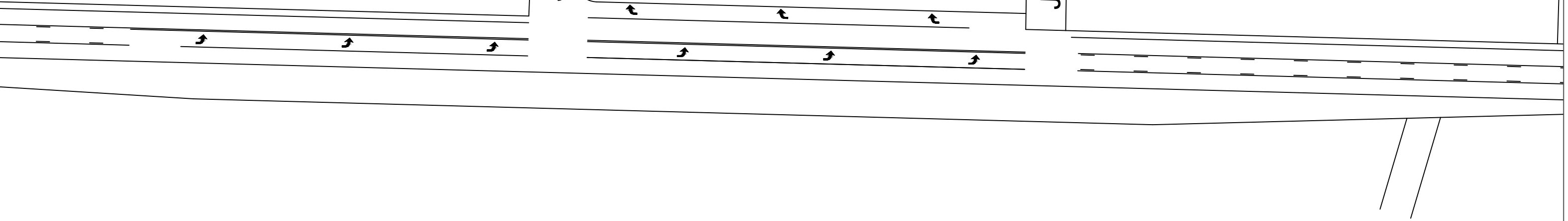

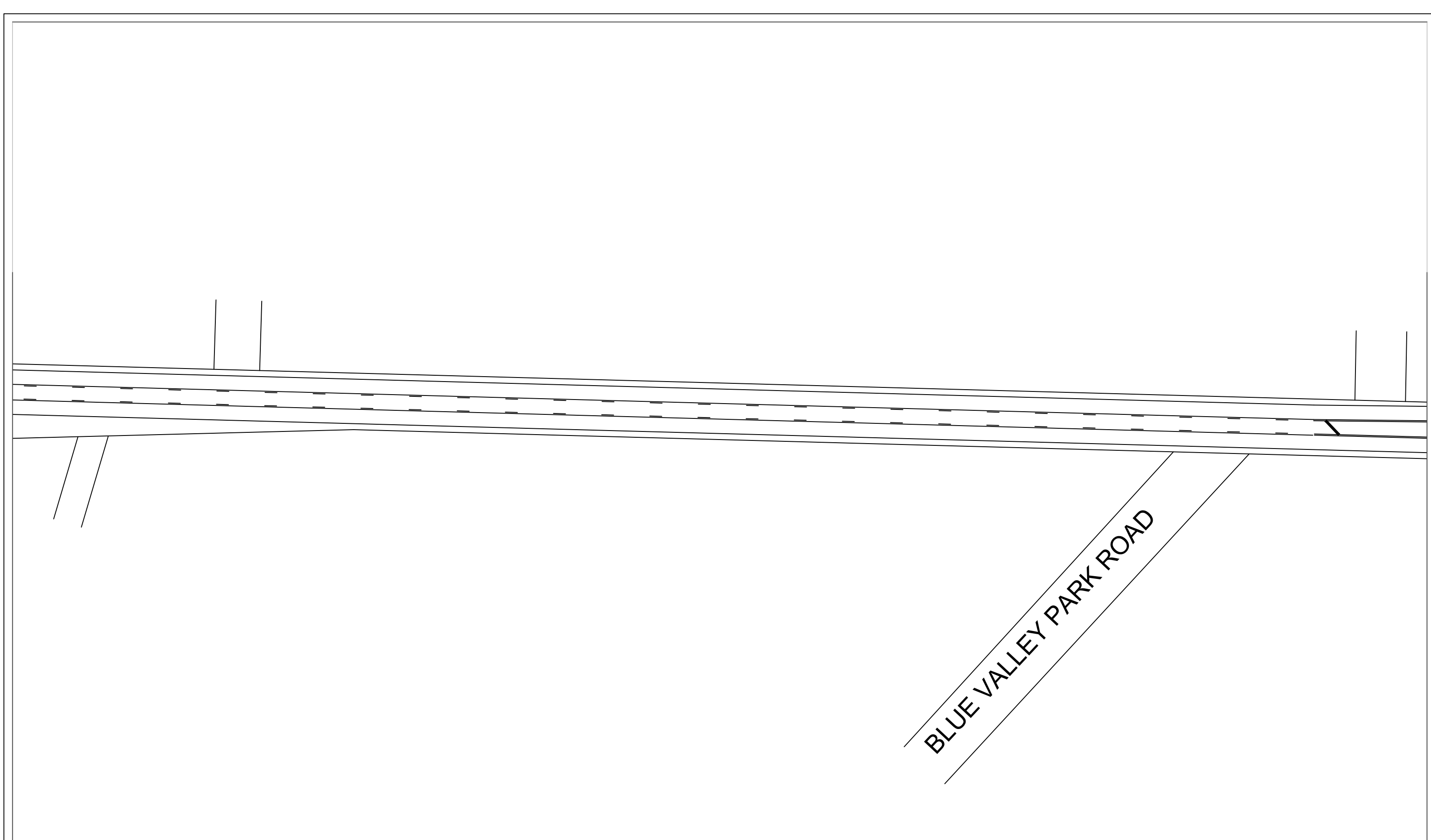



REPLACE SPEED LIMIT 45 SIGN
WITH SPEED LIMIT 40 SIGN

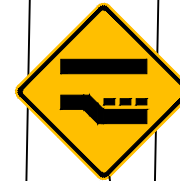

W4-2L
36"x36"

BLUE RIVER

TRANSITION DESIGN AT BRIDGE JOINT

